



## **ACOUSTIC WOOD PANEL INSTALLATION GUIDE**

---

**Ensure you have read and understood all of the installation guides and choose the guide appropriate for you prior to starting.**

- 1.** Finishing In Centre Of Wall
- 2.** Finishing On An Internal Corner
- 3.** Finishing On An External Corner
- 4.** Finishing Around An External Corner

BRING YOUR ASPIRATIONS TO REALITY

# 1. FINISHING IN CENTRE OF WALL

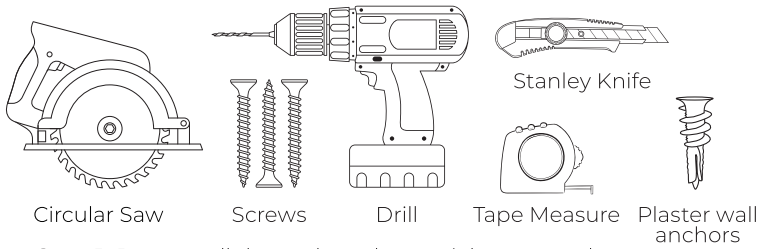

**Step 1:** Prepare all the tools and materials you need.

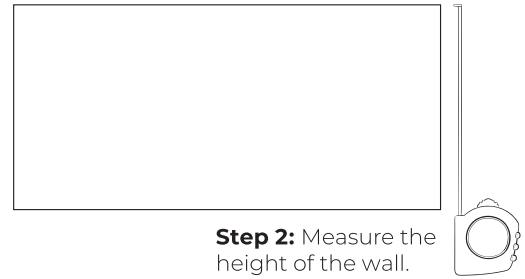

**Step 2:** Measure the height of the wall.

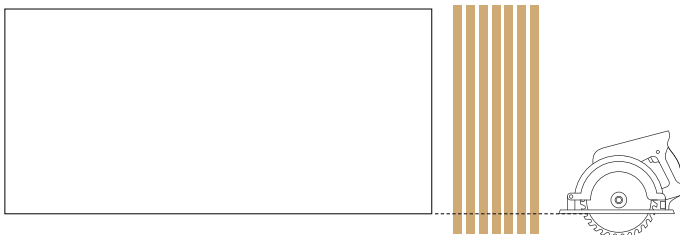

**Step 3:** Cut the acoustic wood panel and end slat to be the same height as the wall.

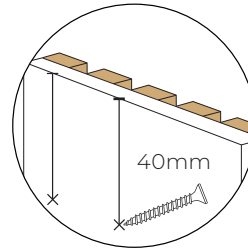

**Step 4:** After cutting acoustic wood panels you may need to resecure the felt to the slats using 15mm staples or screws. Ensure that a screw or staple is minimum 40mm from the top or bottom.

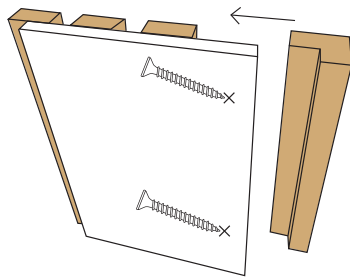

**Step 4.1:** Begin fixing end slat to panel using 15mm screws or staples.

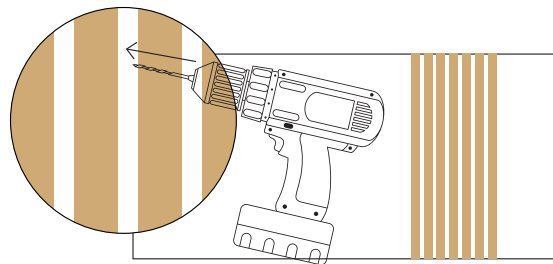

**Step 5:** Place panels in position and begin pre drilling holes.

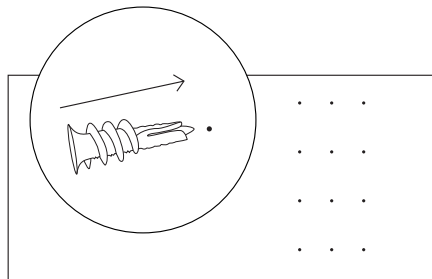

**Step 5.1:** Remove panel and insert 'plaster wall anchors' (wall anchors only required where no timber studs are present to fix to).

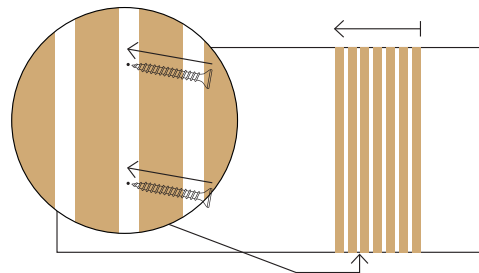

**Step 5.2:** Begin fixing the acoustic wood panels to the wall using 35mm black screws. Place the acoustic wood panel flush with one edge of the wall and screw in using 35mm black screws.

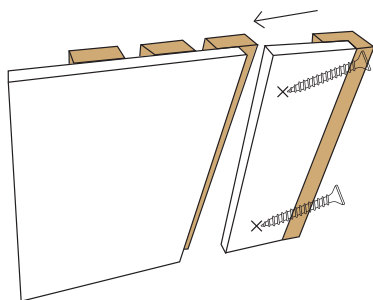

**Step 6:** Fix end slat to last panel using 15mm screws or staples.

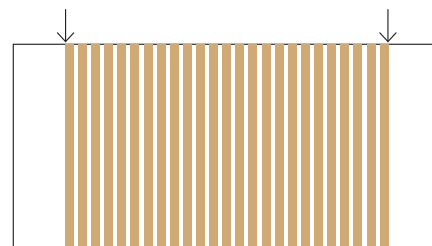

**Step 7:** Your installation is complete!

## 2. FINISHING ON AN INTERNAL CORNER

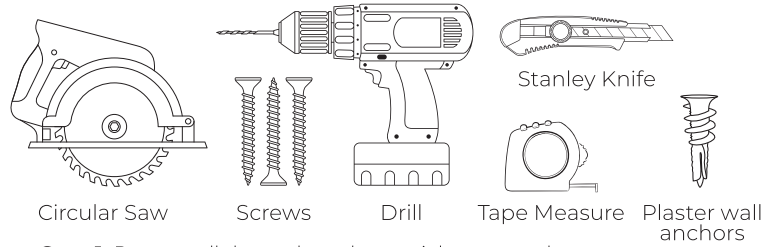

**Step 1:** Prepare all the tools and materials you need.

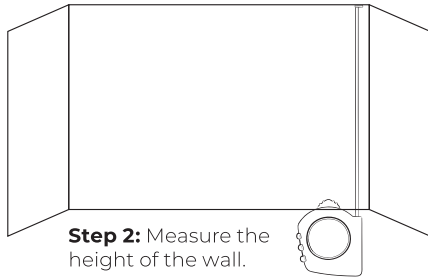

**Step 2:** Measure the height of the wall.

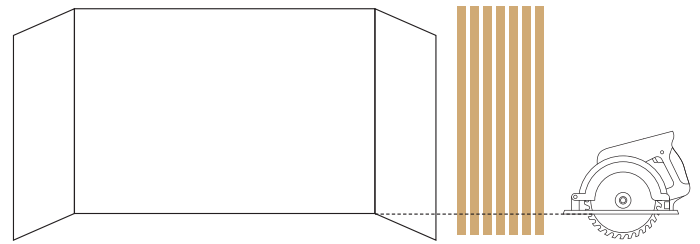

**Step 3:** Cut the acoustic wood panel to be the same height as your wall.

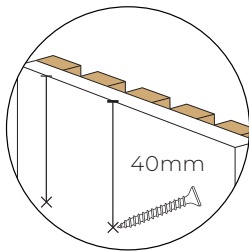

**Step 4:** After cutting acoustic wood panels you may need to resecure the felt to the slats using 15mm staples or screws. Ensure that a screw or staple is minimum 40mm from the top or bottom.

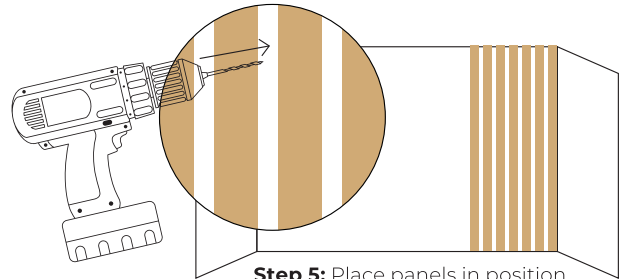

**Step 5:** Place panels in position and begin pre drilling holes.

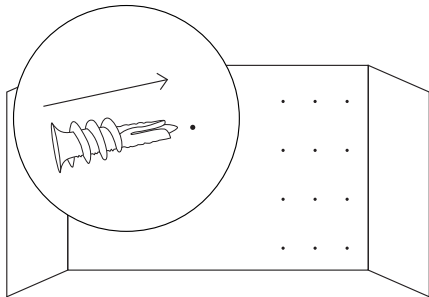

**Step 5.1:** Remove panel and insert 'plaster wall achors' (wall anchors only required where no timber studs are present to fix to).

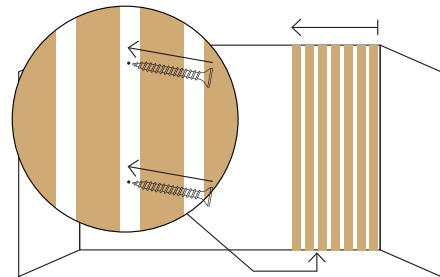

**Step 5.2:** Begin fixing the acoustic wood panels to the wall. Place the acoustic wood panel flush with one edge of the wall and screw in using 35mm black screws.

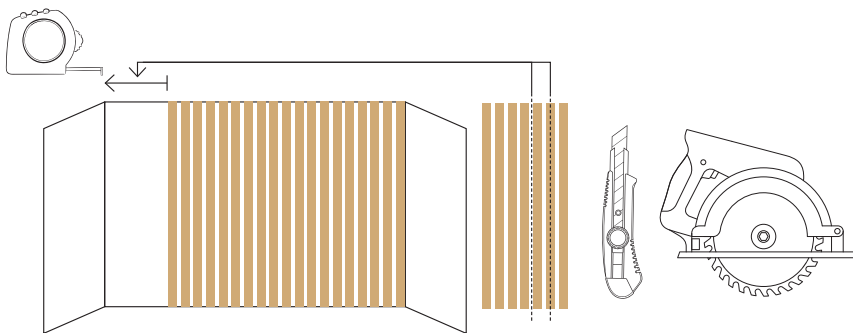

**Step 6:** Measure the remaining wall and cut (with stanley knife through felt or circular saw through slat) your last acoustic panel to fit neatly in the remaining width and install it.

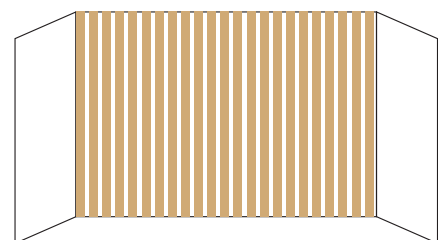

**Step 7:** Your installation is complete!

# 3. FINISHING ON AN EXTERNAL CORNER

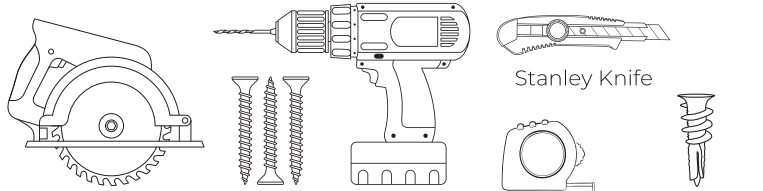

**Step 1:** Prepare all the tools and materials you need.



**Step 2:** Measure the height of the wall.

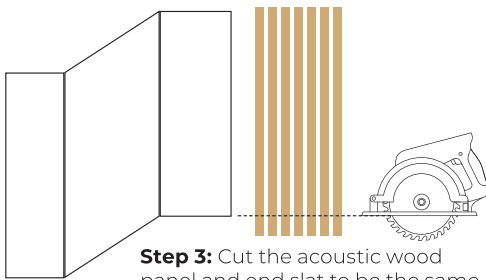

**Step 3:** Cut the acoustic wood panel and end slat to be the same height as the wall.

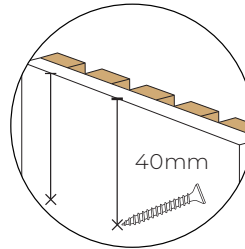

**Step 4:** After cutting acoustic wood panels you may need to resecure the felt to the slats using 15mm staples or screws. Ensure that a screw or staple is minimum 40mm from the top or bottom.

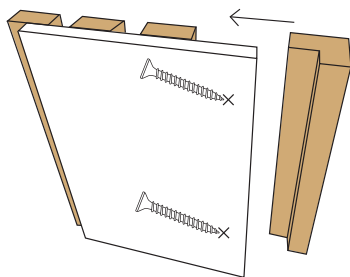

**Step 4.1:** Begin fixing end slat to panel using 15mm screws or staples.

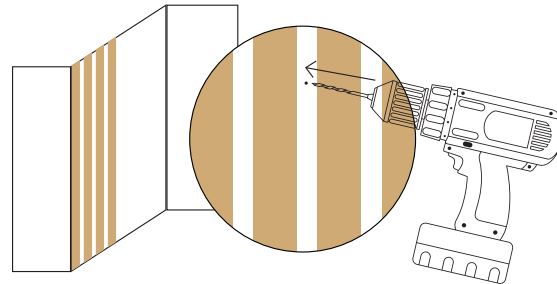

**Step 5:** Place panel flush with external corner and begin pre drilling holes.

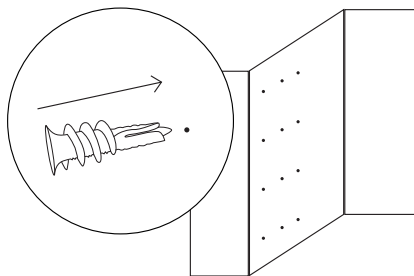

**Step 5.1:** Remove panel and insert 'plaster wall anchors' (wall anchors only required where no timber studs are present to fix to).

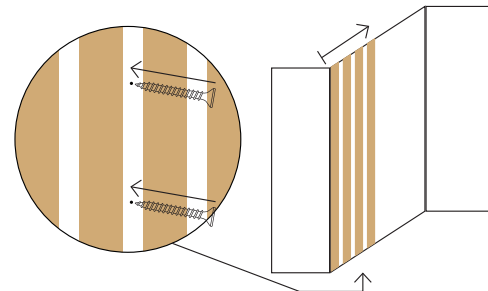

**Step 5.2:** Begin fixing the acoustic wood panels to the wall. Place the acoustic wood panel flush with one edge of the wall and screw in using 35mm black screws.

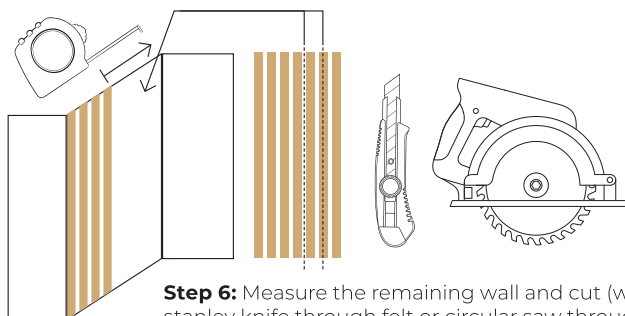

**Step 6:** Measure the remaining wall and cut (with stanley knife through felt or circular saw through slat) your last acoustic wood panel to fit neatly in the remaining width and install it.

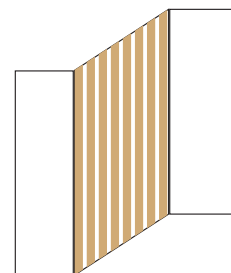

**Step 7:** Your installation is complete!

# 4. FINISHING AROUND AN EXTERNAL CORNER

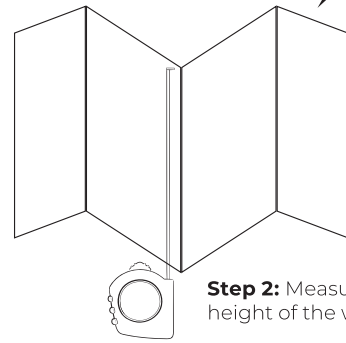
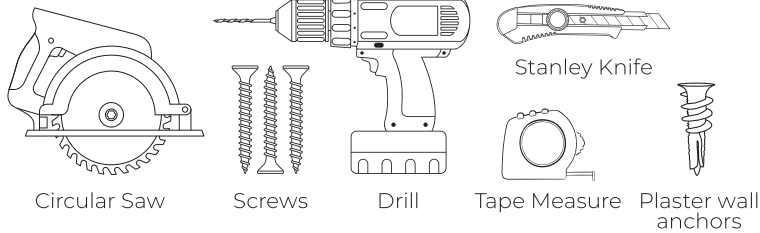

**Step 1:** Prepare all the tools and materials you need.

